

ASSEMBLY STEPS

- STEP 1: PLACE 2 INSULATOR HAVLES TOGETHER UNTIL LOCKED IN PLACE
- STEP 2: AFTER CRIMPING; LOAD CONTACTS INTO INSULATOR. ENSURE WIRE JACKET OD DOES NOT CAUSE ASSEMBLY ISSUES.
*ASSEMBLE BACK SHELL ONTO CABLE BEFORE CRIMPING WIRE
- STEP 3: INSERT INSULATOR INTO ALIGNMENT SLEEVE. PUSH TABS IN TO SECURE INSULATOR
- STEP 4: PLACE COVER OVER ALIGNMENT SLEEVE AND PRESS UNTIL LOCKED INTO PLACE
- STEP 5: CRIMP STRAIN RELIEF ON ALIGNMENT SLEEVE TO SECURE CABLE
- STEP 6:* SLIDE BACKSHELL OVER ALIGNMENT SLEEVE
- STEP 7: PLACE JACKSCREWS IN BACKSHELL ASSEMBLY

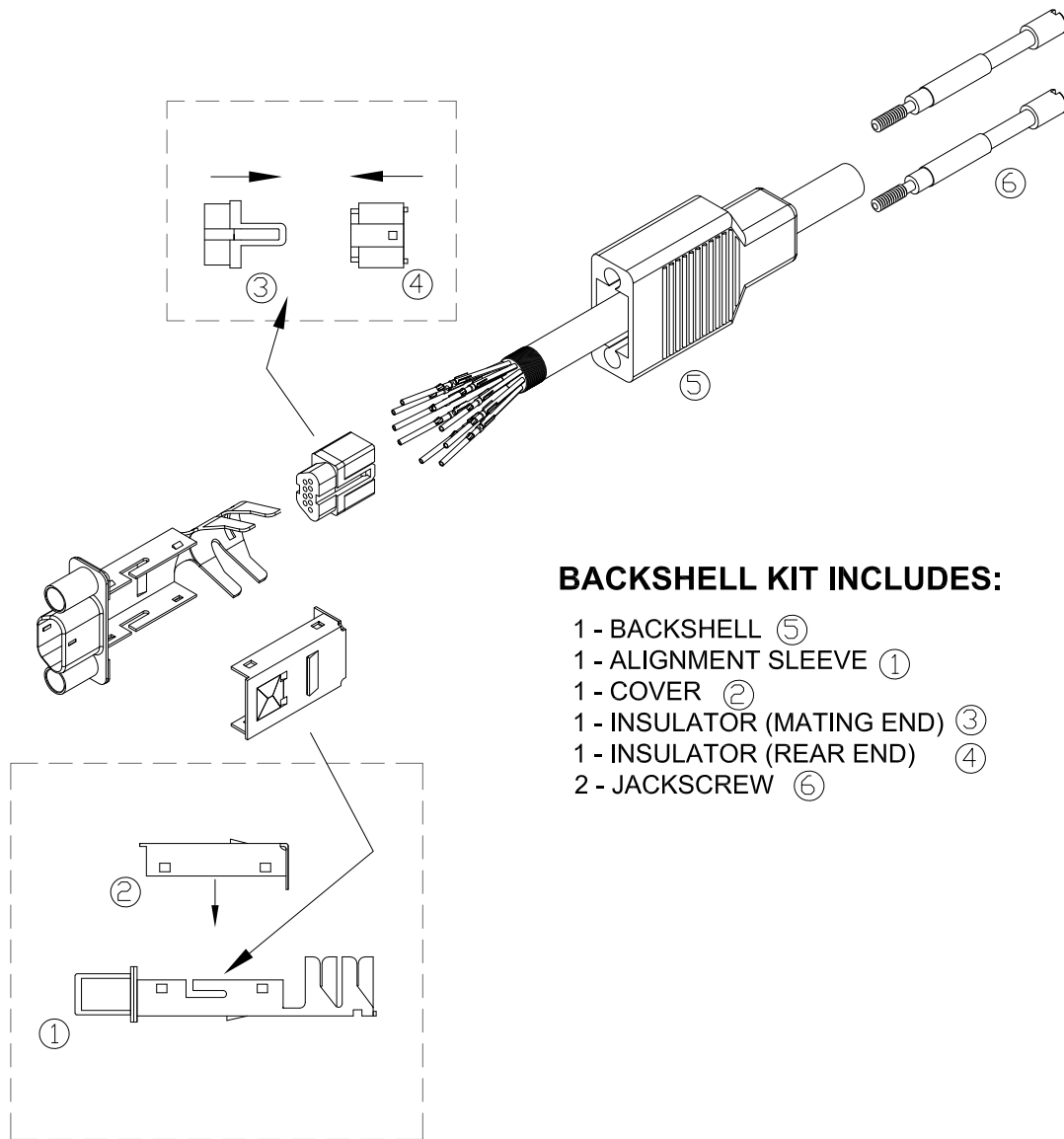

BACKSHELL KIT INCLUDES:

- 1 - BACKSHELL ⑤
- 1 - ALIGNMENT SLEEVE ①
- 1 - COVER ②
- 1 - INSULATOR (MATING END) ③
- 1 - INSULATOR (REAR END) ④
- 2 - JACKSCREW ⑥

MAXIMUM WIRE JACKET OD = 0.039"

960-YYY-010R01Y

1 = KIT
2 = BULK

009 = 9 POSITION
015 = 15 POSITION
025 = 25 POSITION

RoHS COMPLIANT

DO NOT SCALE FROM DRAWING



THESE DRAWINGS AND SPECIFICATIONS ARE THE PROPERTY OF NorComp AND SHALL NOT BE REPRODUCED, COPIED OR USED AS THE BASIS FOR THE MANUFACTURE OR SALE OF APPARATUS WITHOUT WRITTEN PERMISSION.

DRAWN:
M. SIGMON
DATE:
09/01/2011

NorComp

SCALE: NTS	SHEET 1	OF 1	REV 4
DWG NO. 960-YYY-010R01Y			