

10/100/1000 BASE-T Chip LAN Transformer



ALANC10001



4.5 x 3.2 x 3.5 mm
RoHS/RoHS II Compliant
MSL = 1

Features

- Uniform transformer windings
- Fully automated production lines
- Meets IEEE 802.3u and 802.3ab standards
- Compatible with 10 BASE-T, 100 BASE-TX and 1000 BASE-T
- Symmetric Orientation
- Operating temperature range up to -40°C to +85°C
- RoHS Compliant
- 1CT:1CT Transformer

Applications

- Fast and gigabit Ethernet
- Servers, switches and routers
- IP cameras, surveillance, and phone
- Access points
- Industrial computers and robotics
- Networking and communications
- Broadcast video
- Set top box

Part Identification

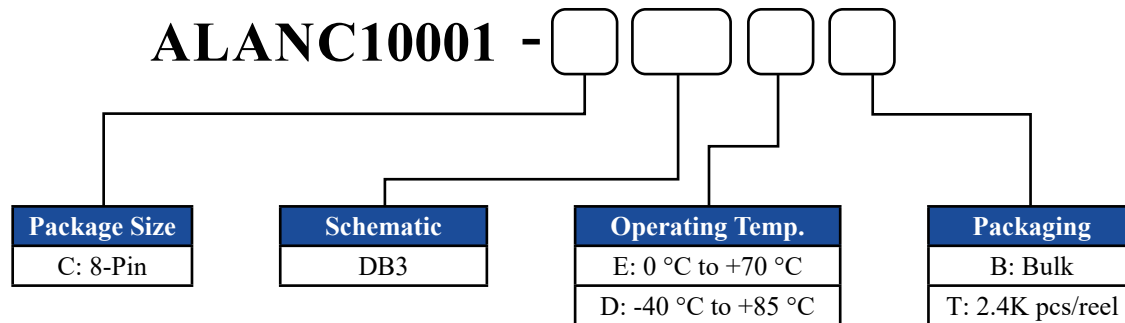

10/100/1000 BASE-T Chip LAN Transformer



ALANC10001



4.5 x 3.2 x 3.5 mm
RoHS/RoHS II Compliant
MSL = 1

Electrical Specifications at 25°C

Part Number	Insertion Loss (dB Max)	Return Loss (dB Min)			
	0.5-100 MHz	1-40 MHz	60 MHz	80 MHz	100 MHz
ALANC10001-CDB3	1.5	18	16	12	10

Part Number	Inductance (uH Min)	Leakage Inductance (uH)	Interwinding Capacitance (pF Max)	DC Resistance (Ω Max)				Hi Pot (Vrms)	Weight (g)
				CT to TD	TD+ to TD-	CT to MX	MX+ to MX-		
ALANC10001-CDB3	200	0.5	35	2	3.5	2.5	5.0	1500	0.12

10/100/1000 BASE-T Chip LAN Transformer



ALANC10001



4.5 x 3.2 x 3.5 mm
RoHS/RoHS II Compliant
MSL = 1

Mechanical Dimensions

C: 8-pin

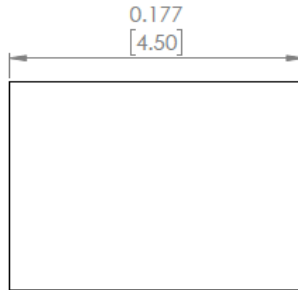

TOP VIEW

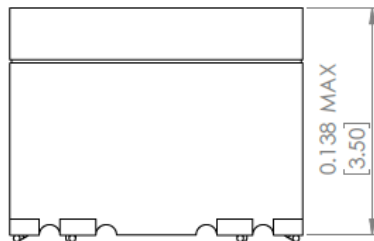

FRONT VIEW

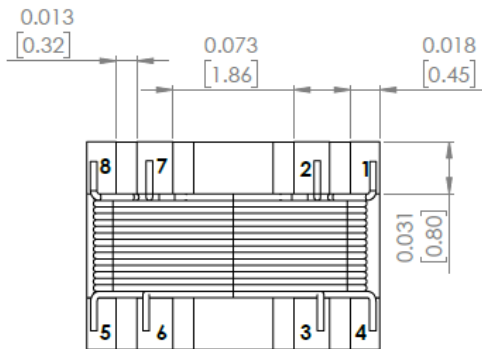

BOTTOM VIEW

RECOMMENDED LAND PATTERN

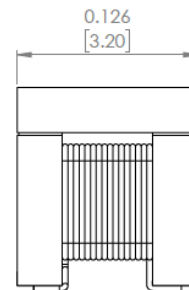
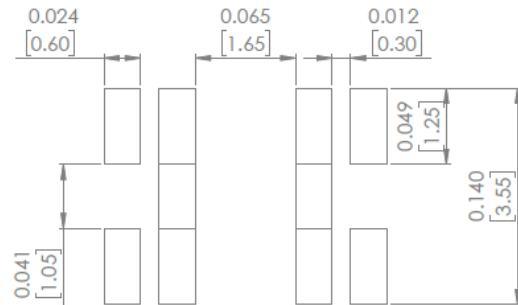

SIDE VIEW

Unless otherwise specified, all tolerances are ± 0.25 in mm
Dimensions: inch/ [mm]



5101 Hidden Creek Ln Spicewood TX 78669
Phone: 512-371-6159 | Fax: 512-351-8858
For terms and conditions of sales, please visit:
www.abracon.com

REVISED: 03-5-21

ABRACON IS
ISO9001-2015
CERTIFIED

10/100/1000 BASE-T Chip LAN Transformer



ALANC10001



4.5 x 3.2 x 3.5 mm
RoHS/RoHS II Compliant
MSL = 1

Schematics

8 - Pin

DB3

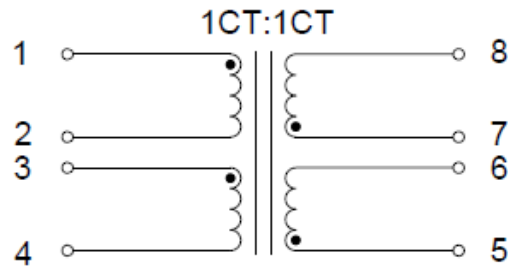

Reflow Profile

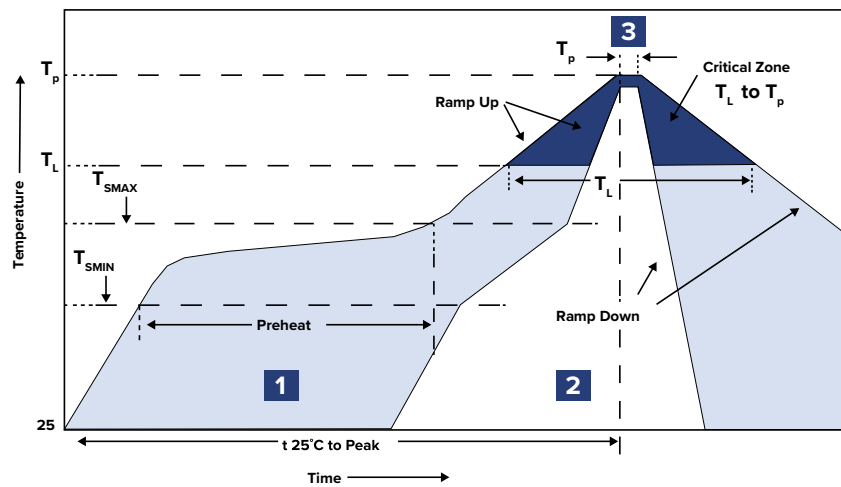

Zone	Description	Temperature	Time
1	Preheat / Soak	$T_{SMIN} \sim T_{SMAX}$ 150°C ~ 200°C	60 ~ 180 sec.
2	Reflow	T_L 245°C	20 ~ 40 sec.
3	Peak heat	T_P 260°C±5°C	10 sec. MAX

10/100/1000 BASE-T Chip LAN Transformer



ALANC10001



4.5 x 3.2 x 3.5 mm
RoHS/RoHS II Compliant
MSL = 1

Packaging

Tape and Reel: 2,400 pcs/reel
Pieces Per Carton: 28,800 pcs
Weight Per Carton: 11.28 kg (approx.)
Dimension of Carton: 345 x 345 x 290 mm

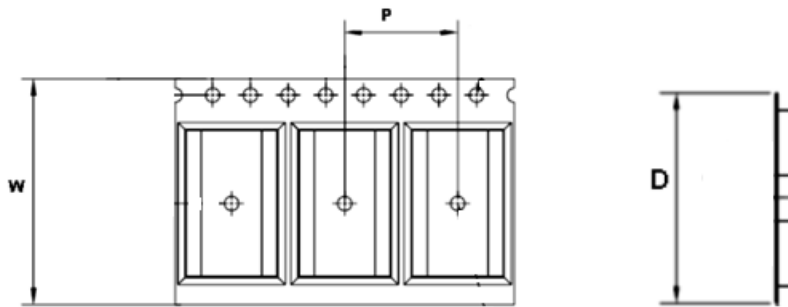

W	P	D
12.0	8.0	Ø330

Dimensions: mm

ATTENTION: Abracon LLC's products are COTS – Commercial-Off-The-Shelf products; suitable for Commercial, Industrial and, where designated, Automotive Applications. Abracon's products are not specifically designed for Military, Aviation, Aerospace, Life-dependent Medical applications or any application requiring high reliability where component failure could result in loss of life and/or property. For applications requiring high reliability and/or presenting an extreme operating environment, written consent and authorization from Abracon LLC is required. Please contact Abracon LLC for more information.



5101 Hidden Creek Ln Spicewood TX 78669
Phone: 512-371-6159 | Fax: 512-351-8858
For terms and conditions of sales, please visit:
www.abracon.com

REVISED: 03-5-21

ABRACON IS
ISO9001-2015
CERTIFIED