

2

1

THIS COPY IS PROVIDED ON A RESTRICTED BASIS AND IS NOT TO BE USED IN ANY WAY DETRIMENTAL TO THE INTERESTS OF PANDUIT CORP.

PANDUIT PART #	STUD SIZE	DIMENSIONS in. [mm]					TOOLS
		L ± .03 [0,8]	W ± .01 [0,3]	C ± .02 [0,5]	M ± .03 [0,8]	H ± .01 [0,3]	
PV10-6LF	#6	1.03 [26,2]	.30 [7,6]	.23 [5,8]	.80 [20,3]	.14 [3,6]	CT-100A CT-600A (CT-550CH) CT-1550 CT-1551 CT-2500 (CT-2550CH)
PV10-8LF	#8	1.05 [26,7]	.30 [7,6]	.23 [5,8]	.80 [20,3]	.16 [4,1]	
PV10-10LF	#10	1.04 [26,4]	.34 [8,6]	.23 [5,8]	.80 [20,3]	.19 [4,8]	
PV10-14LF	1/4"	1.19 [30,2]	.46 [11,7]	.36 [9,1]	.90 [22,9]	.25 [6,4]	

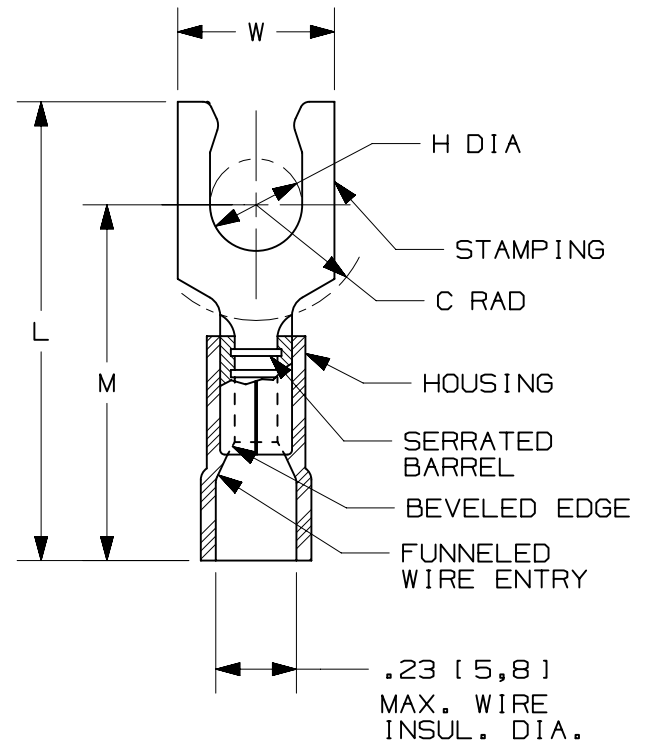

NOTES:

- cULus LISTED FOR:
  - A. #12-10 AWG [4,0-6,0 mm<sup>2</sup>] STRANDED COPPER WIRE
  - B. 221°F [105°C] MAX. OPERATING TEMPERATURE
  - C. 600 V. MAX. VOLTAGE RATING (1000 V. IN SIGNS, FIXTURES & LUMINARIES)
2. SEE [www.panduit.com](http://www.panduit.com) FOR PACKAGE QUANTITIES
3. MATERIAL:
  - A. STAMPING: .04" [1,0] THK COPPER, TIN PLATED
  - B. HOUSING: VINYL, YELLOW
4. DIMENSIONS IN BRACKETS ARE METRIC EQUIVALENT
5. WIRE STRIP LENGTH: 5/16" <sup>+1/32</sup><sub>0</sub> [7,9<sup>+0,8</sup><sub>0</sub>]



REV	DATE	BY	CHK	APR	DESCRIPTION	ECN
12	07/14	MBY	JHNU	RGB	REVISED NOTES, MOVED TOOLS TO TABLE, REVISED CERTIFICATION	N41226BA-A41226
11	10.17.12	JBN	LSM	VMB	REVISED NOTES. UPDATED DRAWING TO CURRENT STANDARDS.	A41226

TITLE <b>LOCKING FORK TERMINALS, NON- INSULATED, #12-10</b>		<b>PANDUIT</b> <sup>TM</sup>
CUSTOMER DRAWING		
ITEM REVISION NAME	N41226BA/12	MATERIAL:  SEE NOTES
DATASET FILE NAME	N41226BA_DC/12A	
UNLESS OTHERWISE SPECIFIED, DIMENSIONAL TOLERANCES ARE: IN [mm]		DRAWING NUMBER: <b>A41226</b>
.XX ±	.XXX ±	
ANGLES ±	THIRD ANGLE PROJECTION	
DRAWN BY DAW	DATE -	CHK LA
SCALE N.T.S.	SHEET 1 OF 1	
SIZE A		

2

1

D101000A/12